

# State Well Report

## Part 1

Mississippi Department of Environmental Quality  
 Office of Land and Water Resources  
 P.O. Box 10631  
 Jackson, MS 39289-0631  
 (601)961-5210  
 (601)354-6938 (fax)

### For Office Use Only:

Aquifer: \_\_\_\_\_  
 Well #: 5-119  
 L. S. Elevation: \_\_\_\_\_  
 E-log #: \_\_\_\_\_

County: Desoto  
 Permit #: GW-39812  
 Irrigation Equipment  
 Driller: \_\_\_\_\_  
 Date drilling completed: 9-23-04

*Irrigation Equipment, Inc.*

State Law requires that this report be prepared by the driller in detail and filed with the Department within 30 days of completion of drilling of the well.

Well Owner Information		Well Location	
Owner Name	<u>Lan Burns</u>	34 45 58N 90 12 6W	
Mailing Address:	<u>Box 160</u>	Latitude: _____ Longitude: _____	
	<u>Lake Cormorant, MS 38641</u>	Method of Lat/Long (circle one): <u>Conventional Survey</u> ,	
City	State	USGS quad, <u>Hand-held GPS</u> , Survey-grade GPS	
662-781-4551		NW 1/4 NW 1/4 Sec. <u>6</u> Twn <u>4S</u> Rng <u>9W</u>	
Telephone No. ( )		Distance _____ Direction _____ Nearest Town _____	
		Miles <u>SW</u> of <u>Hernando</u>	

### Well Data

Purpose of Well (circle one) Home Industrial Public Supply Irrigation Fish Culture Other: \_\_\_\_\_

Date well drilling started: 9-23-04 Date well drilling completed: 9-23-04

If flowing, method of flow regulation: Valve \_\_\_\_\_ Other (describe) \_\_\_\_\_

Static Water Level: 24' feet above or below (circle one) land surface Date measured: 9-27-04

Method of Measurement (circle one) steel tape electric tape air line other: \_\_\_\_\_

Hole depth: 101' Well depth: 101' Well grouted to a depth of 10' feet

Type of grout (circle one): Cement Bentonite Mix

Casing length: 41 feet Casing diameter: 16 inches Type of casing: PVC Sch. 40

Screen length: 60 feet Screen diameter: 16 inches Type of screen: PVC Sch. 40

Screen slot size: .050 inches Setting depth: From 42 feet to 101 feet

Type of completion (circle all applicable): Gravel packed Underreamed Telescoped Open hole Natural Development

Other (describe): \_\_\_\_\_

Top of lap pipe or reduction in casing: \_\_\_\_\_ feet. If telescoped or more than one screen, describe on back of page

Logs run (circle all applicable): No log run Electric Gamma Ray Density Sonic Neutron Other: \_\_\_\_\_

Name of organization running log(s): \_\_\_\_\_

I certify that the well was drilled, constructed, and completed in accordance with all applicable requirements of the Mississippi Department of Environmental Quality and/or the Mississippi Department of Health regulations and state laws.

Irrigation Equipment Inc.  
 Patrick M. Chism 0695

*Patrick M Chism*  
 Signature of Water Well Contractor

Print Name of Water Well Contractor and License No.

RECEIVED  
 OCT 11 2004  
 BY: OLWR

If well telescopes please sketch below and show depths.

J-119

Ground Level

Description of Formations Encountered	From	To
Clay	0	33
Clay/fine sand	34	38
Med. Sand/gravel	39	100
Clay	101	

If more than one screen, show location of each on sketch

Sketch the property layout and include the following: 1) the well location; 2) any permanent structures on the property that may aid in locating the well; 3) any roads, power lines, or other items that may aid in locating the property and the well; 4) indicate direction.

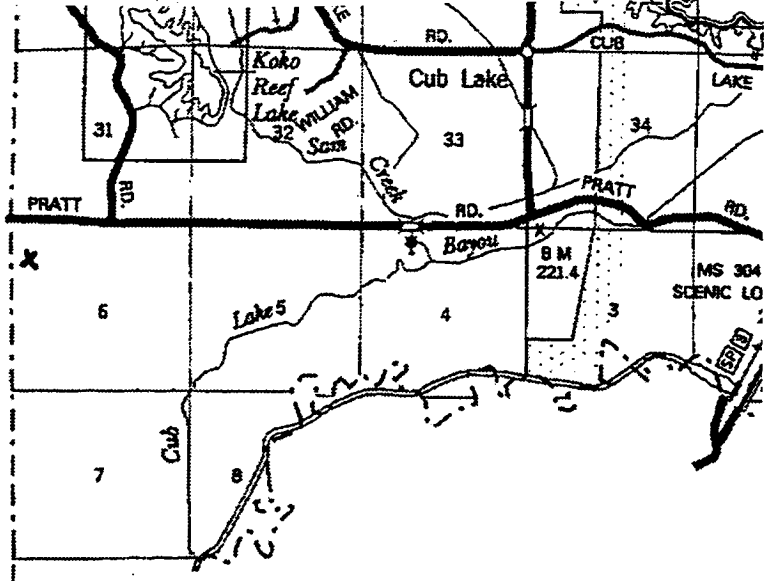

Landowner Name: \_\_\_\_\_

*Patrick M. Chism*

Signature of Water Well Contractor

# STATE WELL REPORT

## Part 2

**Pump Installer's Completion Report**  
 Mississippi Department of Environmental Quality  
 Office of Land and Water Resources  
 P.O. Box 10631  
 Jackson, MS 39289-0631  
 (601)961-5210  
 (601)354-6938 (fax)

County: Desoto  
 Permit # GW-39812  
 Irrigation Equipment  
 Driller: \_\_\_\_\_  
 Date completed: 9-27-04

**For Office Use Only:**

Aquifer: \_\_\_\_\_  
 Well #: 5-119  
 Elevation: \_\_\_\_\_

This report should be prepared by the pump installer in detail and filed with the Department within 30 days of the installation of pump.

Well Owner Information	Well Location
Owner Name: <u>Lan Burns</u>	Latitude: _____ Longitude: _____
Mailing Address: <u>Box 160</u>	Method of Lat/Long (circle one): Conventional Survey, USGS quad, Hand-held GPS, Survey-grade GPS
<u>Lake Cormorant, MS</u>	<u>NW ¼ NW ¼ Sec 6 Twn 4S Rng 9W</u>
City State Zip Code <u>662-781-4551</u>	Distance Direction Nearest Town _____ Miles <u>SW</u> of <u>Hernando</u>
Telephone No. (____) _____	

Pump Type Circle one	Power Type Circle one
Air Lift Jet <input type="checkbox"/> Submersible <input type="checkbox"/>	<input checked="" type="checkbox"/> Diesel Engine Gasoline Engine Natural Gas
Bucket Piston <input type="checkbox"/> <input checked="" type="checkbox"/> Turbine	Electric Motor Hand Tractor PTO
Centrifugal Rotary <input type="checkbox"/> Flowing Well <input type="checkbox"/>	Windmill Other (specify): _____
Other (specify): _____	Horse Power Rating of Motor: <u>60</u>
Date Pump Installed: <u>9-27-04</u>	Setting Depth: <u>70</u> feet
Rated Pump Capacity: <u>2500</u> Gallons Per Minute	Number of Stages: <u>2</u>

Pump Test Data	Method of Measuring Water Level Circle one
Date Well Tested: _____	Air Line Electric Measuring Line <input checked="" type="checkbox"/> Steel Tape
Static Water Level (A): <u>24'</u> Feet Below Land Surface	Other (specify): _____
Pumping Water Level (B): _____ Feet Below Land Surface	For flowing well, measured shut in head: _____ feet
Drawdown [(B) - (A)]: _____ Feet Below Land Surface	Well yielded _____ GPM with a drawdown of _____ feet after _____ hours of pumping
Test Pumping Rate: _____ Gallons Per Minute	
Duration of Pump Test (minimum 4 hours): _____ hours	

I HEREBY CERTIFY that the above statements are true to the best of my knowledge.

Patrick M. Chism 0695  
 Print Name of Pump Installer and License No. (if applicable)

Patrick M Chism  
 Signature of Pump Installer

RECEIVED  
 OCT 11 2004  
 BY: OLWR